

Lawrence County, MO

Property Report Card

Parcel Number: 204018003009016000

Owner Name: MARKS, DAVID L

Situs Address: 1420 ELLIOTT

Mail To Address: 1420 S ELLIOTT

Mail To Address 2:

Mail To City State Zip: AURORA MO 65605-0000

Database Acres: 0

Book/Page: 0347-0860

Section: 18

Township: 26

Range: 25

Date Acquired: 1993-07-01

Land Assessed: 4710

Total Assessed Including Land: 23100

Legal Description: ELLIOTT AVE., S., 1420; BEG 313.5' N & 60' E OF SW CORN OF N 1/2 OF LOT 2 SW (FR 1/4), THENCE E 349, N 209, W 249, S 191, W 100.2, S 24 TO POB

347/860

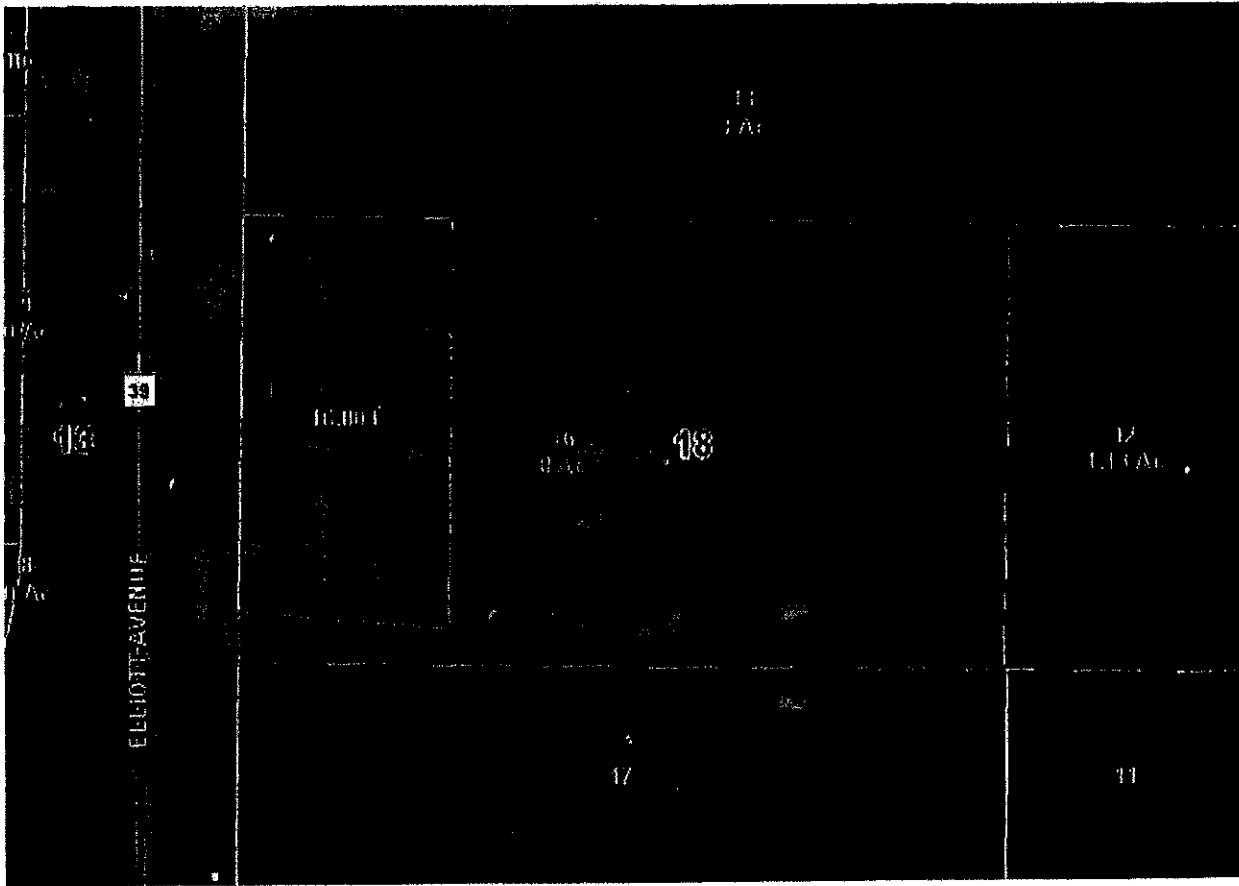

Data contained within this web site was created from record research provided by the county and/or city. Lawrence County, Missouri does not guarantee any accuracies to the data or attribute information displayed, queried, or printed from this web site. This web site is only intended for informational purposes.

Document # 3808 Recorded in book 347 Page 860 (Doc. Washam) RECORDED
Filed for record July 1 1993 at 3:35 P.M. (Jones) Robertson Deputy
Form 2 © 1988 ELKINS-SWYERS CO., SPRINGFIELD, MO. B

QUIT CLAIM DEED

THIS INDENTURE made on the 30TH day of JUNE 19 93, by and between
Sally J. Henson, a single person, formerly Sally J. Marks,
of Lawrence County, Missouri, part y of the first part, and
David L. Marks, a single person,
of the county of Lawrence in the state of Missouri, part y of the second part,
(Address of second party: 1418 South Elliott, Aurora, Missouri 65605)
WITNESSETH, That the said party of the first part, for and in consideration of the sum of
Ten Dollars and other good and valuable consideration DOLLARS
to her paid by the said part y of the second part the receipt of which is hereby acknowledged, do es
these presents, Remise, Release and forever Quit-Claim unto the said part y of the second part, the following described Lots,
Tracts or Parcels of land lying, being and situate in the county of Lawrence and State of Missouri, to-wit:

All of my right, title and interest in and to the following described real estate,
to-wit:

Part of the North Half of Lot 2 of the Southwest Fractional Quarter of Section 18,
Township 26, Range 25, Lawrence County, Missouri, described as follows:
Beginning at a point 522.5 feet North and 60 feet East of the Southwest corner
thereof (said point being on the East right-of-way line of Missouri Route 39, Elliott
Street), thence East 100 feet, thence South 191 feet, thence North 86 degrees 04
minutes West 100.2 feet to said East right-of-way of Missouri Route 39, thence North
along said East right-of-way line 185 feet to the point of beginning.

XX
XX
XX

TO HAVE AND TO HOLD the same with all rights, Immunities, privileges and appurtenances thereto belonging, unto the said
part y of the second part, his heirs and assigns forever so that neither the said part y of the first part nor her
heirs nor any other person or persons for her or in her name or behalf shall or will
hereafter claim or demand any right or title to the aforesaid premises or any part thereof; but they and every one of them shall be,
by these presents, excluded and forever barred

IN WITNESS WHEREOF, I have hereunto set my hand and seal, this the 30TH
day of JUNE A. D. 19 93.

Sally J. Henson (SEAL)
Sally J. Henson (SEAL)
..... (SEAL)
..... (SEAL)

*Erase or draw line through clause if not needed.

ESCO

STATE OF MISSOURI,)
 County of _____) ss. On the _____ day of _____ A. D. 19____
 before me personally appeared _____
 and _____, his wife
 to me known to be the persons described in and who executed the foregoing instrument, and acknowledged that they executed the same
 as their free act and deed.

In Testimony Whereof, I have hereunto set my hand and affixed my official seal, at my office in _____
 the day and year first above written.
 My commission as Notary Public will expire on the _____ day of _____, 19____.
 _____ Notary Public.

STATE OF MISSOURI,)
 County of LAWRENCE) ss. On the 30TH day of JUNE A. D. 1993,
 before me personally appeared Sally J. Henson
 to me known to be the person described in and who executed the foregoing instrument, and acknowledged that she
 executed the same as her free act and deed. And the said Sally J. Henson
 further declared herself to be single and unmarried.

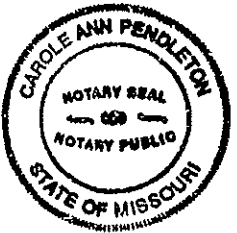

In Testimony Whereof, I have hereunto set my hand and affixed my official seal, at my office in
 Mount Vernon, Missouri, the day and year first above written.
 My commission as Notary Public will expire on the 28th day of September, 1994.
 (Seal) *Carole Ann Pendleton* Notary Public.
 Carole Ann Pendleton

3808

QUIT CLAIM DEED
 STANDARD MISSOURI FORM

FROM _____

TO _____

Indexed

Filed for record this 1st day of July A. D. 1993
 at 3 o'clock 35 minutes P. M.
 Don Washburn Recorder.
 Pam Robertson Deputy.
 Recorder's Fee \$12.00
 Andrew Hager Mailing Address.
 1988 Elkins-Swyers Co., Springfield, Mo. - R-9504

IN THE RECORDER'S OFFICE
 STATE OF MISSOURI,)
 County of LAWRENCE) ss.
 I, Don Washburn Recorder of
 said County, do hereby certify that the within instru-
 ment of writing was, on the 1st
 day of July A. D. 19 93
 at 3 o'clock 35 minutes P. M.
 duly filed for record, and is now Recorded in the
 Records of this office in Book 347 at page 860.

IN WITNESS WHEREOF, I have hereunto set my
 hand and affixed my official seal at
 Mt. Vernon, Missouri this
 1st day of July A. D. 19 93
 Don Washburn Recorder.
 Patricia Fees Deputy.
 Recorder's Fee \$ _____

THIS DOCUMENT PREPARED BY
 ANDREW J. HAIGER, JR., ATTORNEY AT LAW
 MOUNT VERNON, MISSOURI